

16 March 2023

# Community Reference Group

Mt Cook Developments  
Rolleston, Arlington



**Kāinga Ora**  
Homes and Communities



# Agenda

1. Welcome and Introductions
2. Previous minutes and actions
3. Construction updates for Arlington
4. Construction updates for Rolleston
5. Single Site Supported Housing update
6. Any other business
7. Close



# Arlington Update, March 2023

## Construction

- All Piles for Block A&B are in the ground
- Defect checks and pile remediation underway
- Main earthworks and site stabilisation nearing completion
- Service installation underway (Supply water, wastewater stormwater upgrades)
- Roading preparation to be completed post service installation

## Next steps

- Procurement underway for Blocks A, B and X
- Tender release for Blocks H&I and remaining site wide civils.









# Rolleston Development

## Overview – March 2023

### Block A:

- Balconies installed, external cladding nearing completion
- Linings and decoration have commenced

### Block B:

- GIB linings well progressed
- Glazing being installed to curtainwall

### Block C:

- Scaffold dropped in places, balconies due shortly
- Decoration, flooring and kitchen install now underway

### Block D:

- A mix of internal and external works continue
- Windows and glazing starting to be installed







## Block A

Cladding nearing completion and external works have commenced to the front of the building.











## Block B

Cladding works ongoing with good progress made over recent weeks.

Linings continue to be installed internally.

Balconies due to be installed in the next 4 weeks.





## Block C

Balconies due within the next 4 weeks once scaffold is struck.

Decoration, bathrooms and kitchen installs commencing.

Civils work, predominantly underground services, are now being installed through the centre of the site.





## Block C Internals





## Block D

Scaffold struck to allow  
install of services below

Services, insulation and  
linings install continues

Steep landscaped bank  
to the rear of the block  
now well progressed



# Schedule of Accommodation

Block A: GF – 4 x 2B / FF – 4 x 2B / SF – 4 x 2B / 1 x 2ST Hse  
13no.

Block B: GF – 2 x 2B / FF – 2 x 2B / SF – 2 x 2B / 1 x 2ST Hse  
7no.

Block C: GF – 3 x 1B / 3 x 2B  
20no. FF – 4 x 1B / 3 x 2B  
SF – 4 x 1B / 3 x 2B

Block D: GF – 3 x 1B  
40no. FF – 5 x 1B / 6 x ST  
SF – 7 x 1B / 6 x ST  
TF – 7 x 1B / 3 x ST  
FRF – 3 x 1B



Legend:  
HSE – House (2 Storey)  
GF - Ground Floor  
FF – First Floor  
SF – Second Floor  
TF – Third Floor  
FRF – Fourth Floor

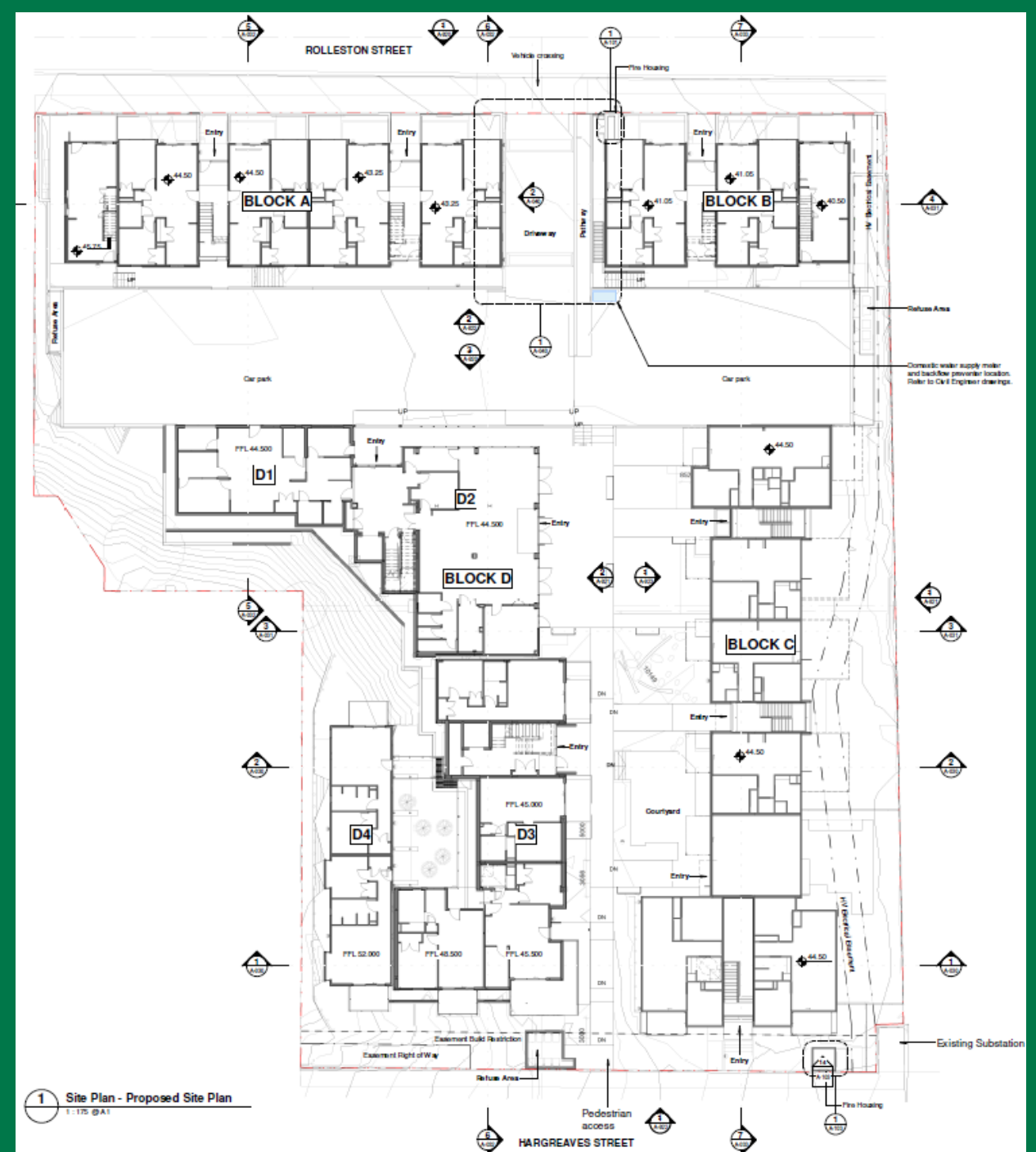



March 2023

# Supported housing Rolleston Development

Alice Daniel-Kirk - Manager Housing  
Wellbeing

Kathy Furfie – Manager Operations



**Kāinga Ora**  
Homes and Communities

