

New homes coming to Abbott Street

DECEMBER 2023



The building of much needed new homes will start in your neighbourhood soon. The development will help meet the urgent need for social housing in Gisborne.

New, modern, healthy homes will be built by Kāinga Ora – Homes and Communities at 7 Abbott Street. The projects will result in warm, dry homes for two whānau most in need.

What is being built?

- 1 x 5-bedroom, two-storey home with garage
- 1 x 3-bedroom, two-storey home

Timeline (approximate)

| | |
|---------------------|------------|
| Site preparation | early 2024 |
| Start construction | mid 2024 |
| Finish construction | late-2024 |

This development will get more whānau out of unsuitable accommodation and into a healthy place to call home. The new, low maintenance homes will be fully insulated, with carpets, curtains and double glazing.



www.kaingaora.govt.nz



Te Kāwanatanga o Aotearoa
New Zealand Government

Kāinga Ora
Homes and Communities

Questions?

If you have any questions, please contact:

Theo Akroyd

Kāinga Ora

East North Island Community Engagement Team, Gisborne

Phone: 021 465 495

Email:

theo.akroyd@kaingaora.govt.nz



Keeping disruption to a minimum

Site, noise and traffic management plans are in place for this development. These provide rules and guidelines about what happens during construction.

The plans will cover items like the hours during which work can be carried out, where contractors can park their vehicles and the control of dust and noise.

When construction begins, we expect building activity to take place between 7am and 6pm Monday to Friday and 8am to 5pm on Saturdays, but not on Sundays and public holidays.

Who will live in the new homes?

Kāinga Ora's dedicated placement team ensure careful and considered matching of people to these homes, people who will live well together and as part of the wider suburb. The homes will be matched to individuals and families on the Ministry of Social Development's Housing Register with the highest priority for a home of that size and in that location. Kāinga Ora works hard to ensure people are placed in homes that best meet their needs, so they can live well in their home and thrive in their community. Consideration is given to whānau who have an existing connection to Te Hapara.

Supporting customers

Kāinga Ora helps our customers settle into their new home and community. A key focus is to ensure that a customer understands their responsibilities. That includes being a good neighbour and member of the community. New ways of supporting customers and helping them connect to support services when they need it, have recently been put in place.

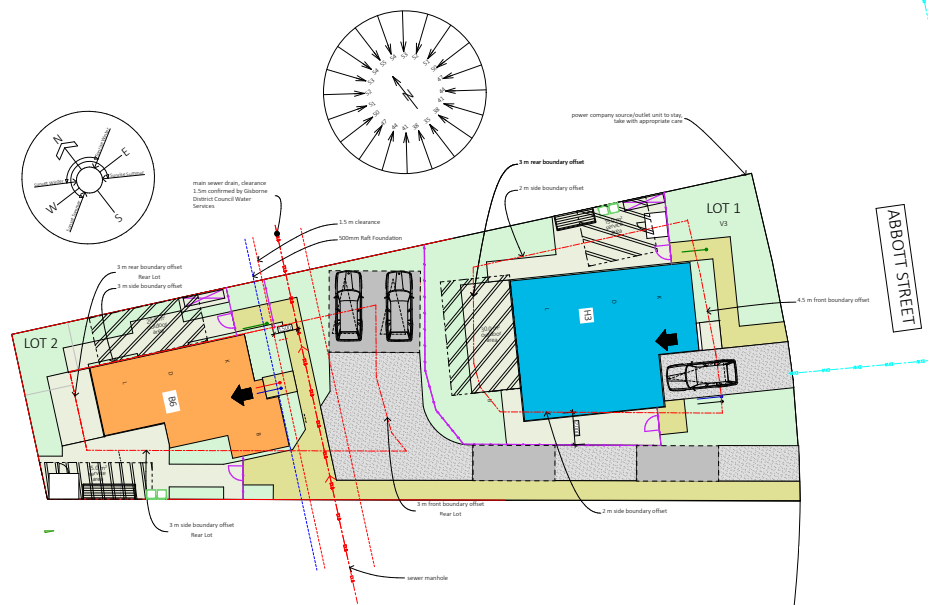

www.kaingaora.govt.nz

Kāinga Ora
Homes and Communities